

Board/Committee:	COMMUNITY BOARD
Date of meeting:	27 TH JUNE 2018
Title:	MANOR WAY OPEN SPACE
Author:	HEAD OF STREETSCENE
Status:	FOR DECISION

Purpose

The purpose of this report is to seek approval to carry out a public consultation regarding the use of the open space at Manor Way, Lee-on-the-Solent.

Recommendation

The Board authorises The Head of Streetscene to carry out a public consultation.

1. Background

- 1.1 At the meeting of the Economic Development Board held on 16th September 2015 members approved the acquisition of the land at manor Way, Lee-on-the-Solent.

2. Report

- 2.1 The land at Manor Way, Lee-on-the-Solent is designated within the Local Plan as open space. (Appendix A)
- 2.2 It is proposed to create a rest gardens to the front of the site with allotments on the remainder with associated infrastructure. (Appendix B)
- 2.3 A public consultation is carried out to seek resident's views on the use of the space and report back to members at a future Community Board.

3 Risk Assessment

- 3.1 The Council is required to maintain the land as part of its open land assets until such time the use of the land is agreed.

4. **Conclusion**

- 4.1 A further report will be presented to the Community Board following the public consultation.

Financial Services comments:	Maintenance costs will need to be budgeted for within the revenue accounts.
Legal Services comments:	None for the purposes of this report.
Crime and Disorder:	No comments.
Equality and Diversity:	
Service Improvement Plan implications:	Outcomes of the Key Actions which require significant input to and/or implementation of activities in Gosport will be included in the Service Improvement Plan as required.
Corporate Plan:	The Action Plan assists Gosport to achieve the Mission Statement and Core Values whilst contributing to our five strategic priorities.
Risk Assessment:	Refer to paragraph 3.1
Background papers:	None.
Appendices/Enclosures: Appendix 'A'	Appendix A - Plan of Land at Manor Way. Appendix B – Plan of proposed Rest Gardens and Allotments.
Report author/Lead Officer:	Stevyn Ricketts (5282)

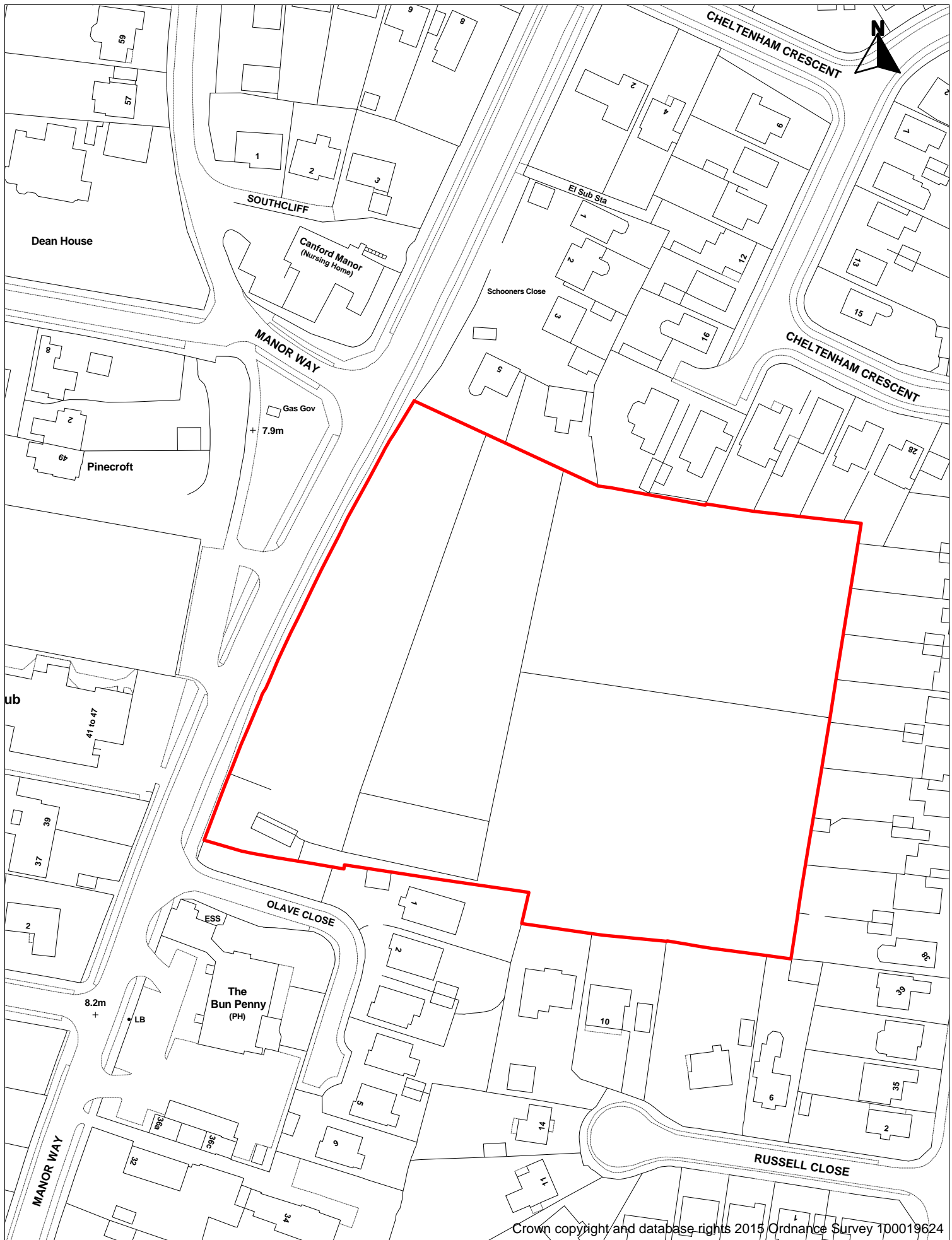

GOSPORT
Borough Council

DATE : 09/02/2015

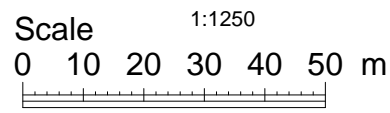

If this map has been transmitted electronically, use the scale bar in preference to the written scale

AMENITY GRASS MAINTENANCE STRIP

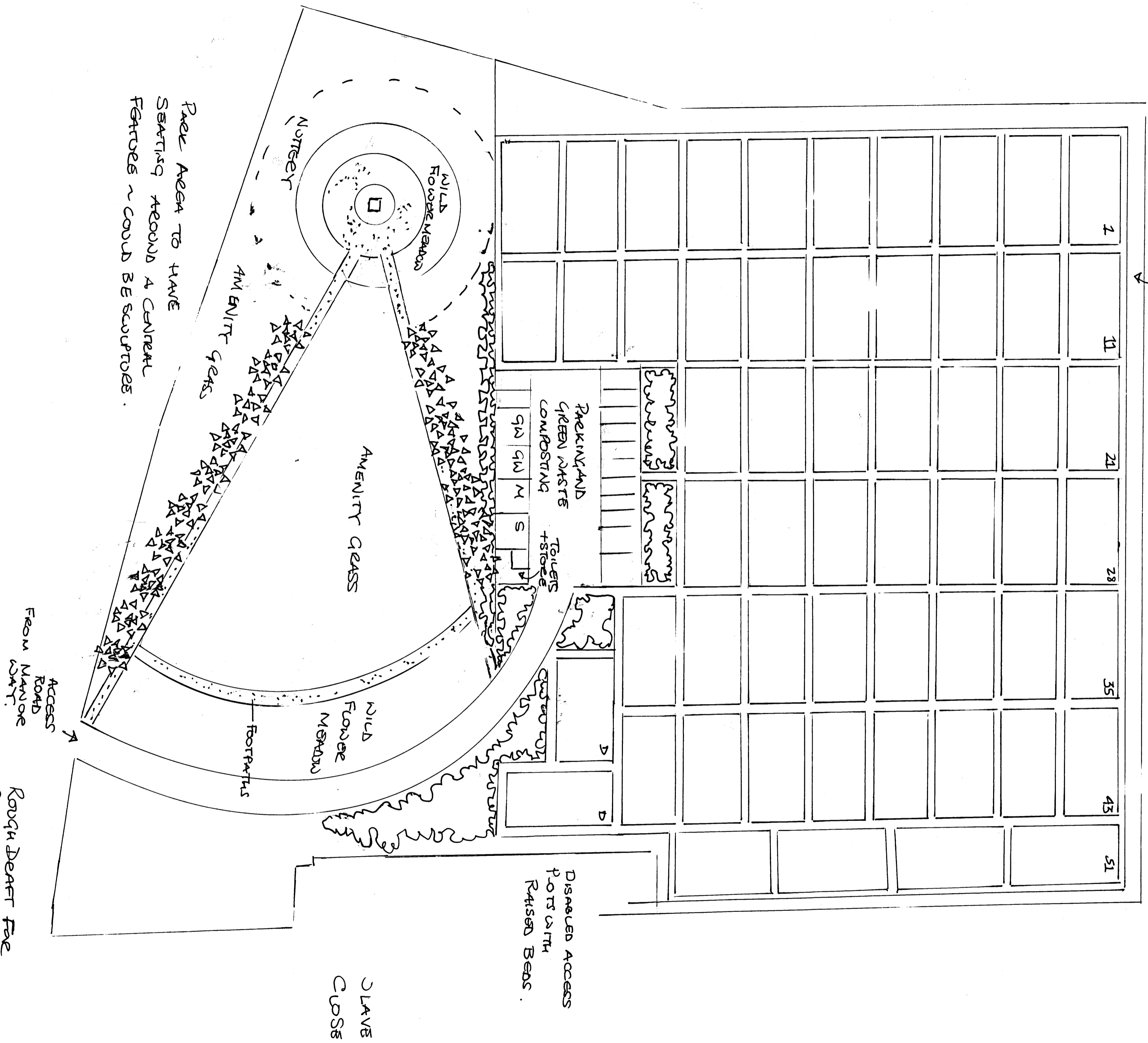

PARK AREA TO HAVE SEATING AROUND A CENTRAL FEATURE ~ COULD BE SCULPTURE.

ROUGH DRAFT FOR POSSIBLE LAYOUT OF NEW AUTOMOUNT SITE AND PARK AT MANORE WAY LEE ON THE SOUTH
SCALE 1:400